



LanLight[®]
Smart Supply System

Modular installation solution for the
flexible supply of office workplaces

office	industry	traffic	shopping	public	sports
--------	----------	---------	----------	--------	--------



Energy, data, media and light, all from one source Flexible, diverse and fit for the future

The use of office space is in a constant state of flux, and office layouts adapt to differing tasks and methods of work. The only constant factor is the requirement for energy, data connections, media and light. The key to the sustainable use of modern, dynamic office environments lies in intelligent and flexible supply systems that are able to adapt to the constantly changing demands. LanLight presents the solution in a highly simple way. LanLight brings

energy, network connectivity, media connection and even lighting together within a modular, multifunctional system, allowing with integral modularity the flexible use and design of office areas. The supply system creates a systematic orderliness for connection of workplaces, thus also increasing safety, and with its clear design and high quality materials it blends harmoniously and discreetly into the general office ambience.

i

The LanLight system partner

LanLight is manufactured by the system partnership of technology experts Bachmann and Siteco.

Bachmann is a specialist for IT power distribution and energy management. Siteco is one of the leading developers and manufacturers of professional lighting solutions in the office sector.

LanLight serves to combine the expertise of both partners and makes available a solution with which energy, data, media and light come together in a modular, sophisticated and highly functional unit.

**BACH
MANN**

siteco



LanLight ...

- enables precise, point supply of workstations
- makes available energy, data connection, media connections and light
- is modular and multifunctional – from the cable outlet via the floor tank and up to the mobile energy pole (with or without luminaire mounting)
- has a sophisticated design and harmonious appearance
- avoids tangled cables below the desk
- makes optimal lighting available



The basis is what matters Modular, multifunctional, sustainable

LanLight adapts easily to specific demands because of the modular design of its system components. The basis module consists of the base unit that according to user requirements can be configured with a variety of components either directly or later. In this way the base unit becomes a simple cable outlet, a compact floor tank or a docking station for the mobile high-tech light pole. Everything at one point!

The LanLight basis module can accommodate various module inserts: floor tank inserts for all media are available, ranging from safety plugs to HDMI sockets that when desired can be delivered fully pre-assembled and with tested connection cables.

A special feature: for equipping the basis module with the mobile energy pole, LanLight

has a new design for self-contacting that establishes all connections with a single plugging step.

The mounting of all modules is highly simple: they are just inserted into the base unit and fastened. The carrying elements and plug-in systems have extremely compact dimensions, enabling mounting in very tight spaces. LanLight is installed in a drill-hole size of just 152 mm in diameter, and even the fixing components for the luminaire are concealed. This uncomplicated method of mounting, the compact design and highly functional modularity mean that installations and energy consumers are only integrated where they will really be used. This in turn enables LanLight to be installed according to specific requirements and just as easily dismantled. The advantage: individual system components are used again and again following restructuring, and the usual provision of installations is no longer necessary because installations are only set up where they are really needed.



LanLight offers ...

- various cable outlets such as flat lids and lift lids
- a floor tank with inserts for many applications (custom module)
- pluggable mobile energy poles with two circuits and up to eight data connections with self-contacting interface (mobile pole)
- pluggable energy poles with two circuits and up to eight data connections with connection field for patch cable (patch pole)
- a pluggable luminaire module, single-sided, with pan-and-tilt luminaire head
- a pluggable luminaire module, double-sided, with pan-and-tilt luminaire head

For today's building installations, future-proof data security is of major importance. This is why LanLight has network components with self-contacting sourced from the technology partner Tyco Electronics.



i

Self-contacting with plug-in technology from Tyco Electronics

LanLight for the first time incorporates the special feature of self-contacting for energy poles. With this innovative solution, over 70 pins are contacted in one plugging step and simultaneously a central, high stability traction of the mechanical fixing components is achieved. The data interface is completely transparent and with use of Cat. 7_A network components is without performance losses in an E_A (ISO/IEC 11801 Amd. 2)

link. Data transmission rates of 10 Gbit/s are achieved up to the connection point at desk height. The LanLight cooperation partner Tyco Electronics ensures quality of the self-contacting network componen

 **Tyco Electronics**

Installation with consolidation points

Maximum flexibility, minimum mounting effort

LanLight has been developed for modern building installations with cavity floors. With a maximum configuration of four circuits and eight data connections and with its compact dimensions, LanLight with plug and play modularity is a future-fit and attractive alternative to the classic, fixed floor tanks without expansion possibilities. LanLight reveals its true performance potential though together with consolidation points.

If consolidation points (CP) are planned as decentral distribution points, the LanLight module inserts with pre-assembled connection cables become on-site, tested connection units. These are integrated into the basis module with cable harness and plug and

then plugged in at the CP. In this way each point in the room can be reached without having to modify the infrastructure. If a connection point is missing, this is upgraded with a conventional drill.

In this way LanLight reduces the usual, complex construction work required with initial installations, keeping the restructuring of supply systems to a minimum. Instead of complicated installation work, electricity supply, data network and lighting can be established in a single work process.

The supply facilities are no longer a fixed component of the building but are moved around with users and user requirements.



Consolidation points

With consolidation points, LanLight reveals its true potential as a modular, functional and flexible supply system that can be installed in just a few steps and operated without subsequent technical approval. The inlets for LanLight are simply bored in the cavity floor with a hand drill and 152 mm drill bit, and the base unit is braced via hex key with the integrated claw fasteners (clamping range 20-70 mm). For cavity floors the 152 mm casing body can be used. The modules are then simply patched to the CP. A cable length of up to eight metres is optimal.

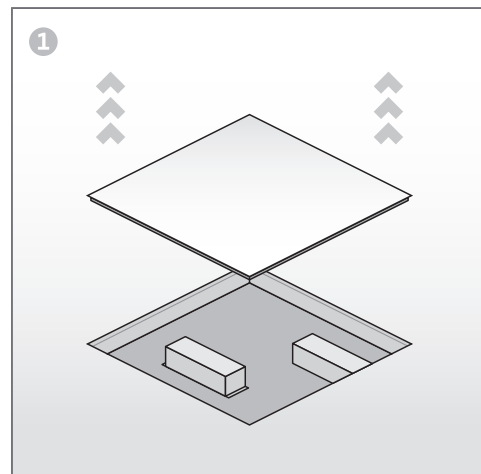

Together with the consolidation points, LanLight can reach nearly all points in a room for the supply of energy, data, media and light. Cable lengths of up to 9 metres are optimal.

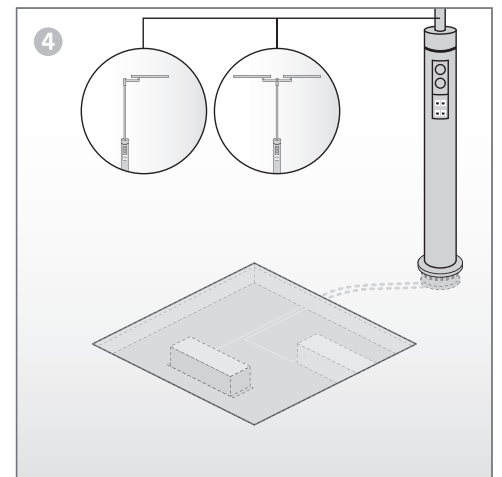
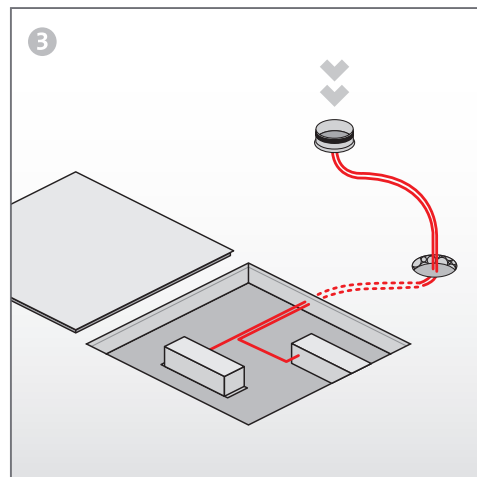
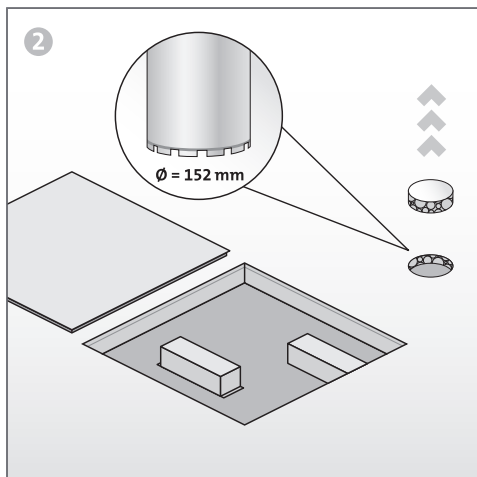
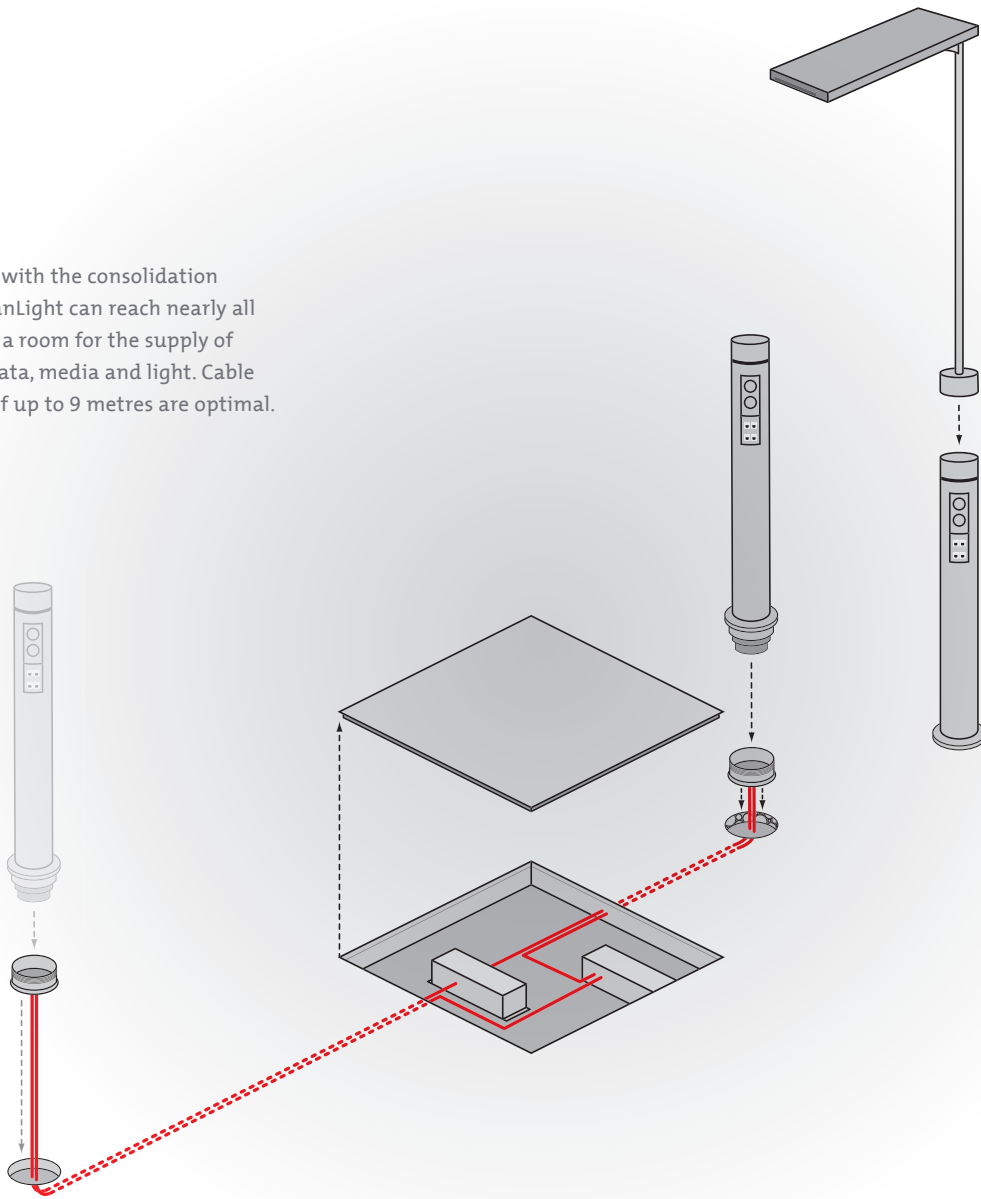



LanLight with ELDACON® light modules Lighting quality and flexibility

A high quality of light promotes well-being and the ability to concentrate, makes work more efficient and also aids creativity. LanLight in the expansion stage as energy pole with ELDACON® light modules makes available a solution that guarantees good light for office areas.

Optimal light results from lighting having a high indirect component that in turn achieves a pleasant room ambience, harmoniously distributes luminance and minimises direct and reflected glare.

The LanLight ELDACON® light module optics, based on highly precise microprismatics, create a homogenous distribution of light upon the working plane with a high, glare-free direct component. The balanced contrast creates a pleasant atmosphere and illumination that satisfies current standards for VDU workstations. And the module with its high quality manufacturing and design

blends homogeneously with the complete appearance of the LanLight module, thus adapting both technically and optically to the requirements of modern office environments.

The ELDACON® light module is mounted just as simply as other LanLight components: luminaire mounting is self-contacting and installed in just a few steps, thus making an upgrading of existing LanLight solutions highly simple.



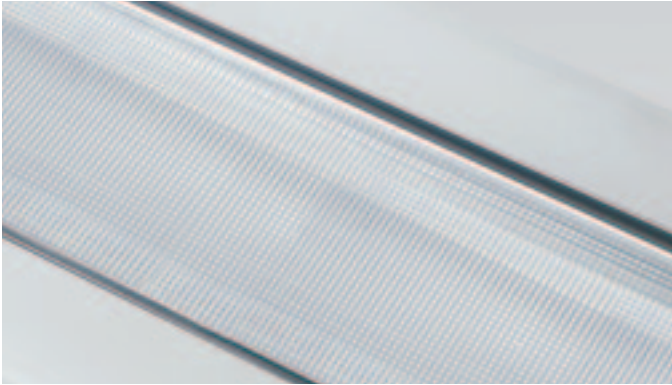

Luminaires with ELDAON® microprismatic technology guide light uniformly onto the working plane.



The special ELDAON® light control system enables completely flexible arrangements of screens on workplaces, because direct and reflected glare is cut to a minimum.

i

ELDAON® – luminaire module with double joint

The head of the ELDAON® luminaire module is equipped with a double joint. This enables even more design flexibility for office layouts with LanLight modules. The double joint allows the luminaire head to be aligned along two axes, thereby also enabling positioning above a double workstation when pole and longitudinal axis of the double workstation are slightly offset during installation. This ensures that all workplaces are optimally supplied with light, and that with every desktop arrangement a continuous, harmonious appearance of workplace and luminaire positioning is achieved.

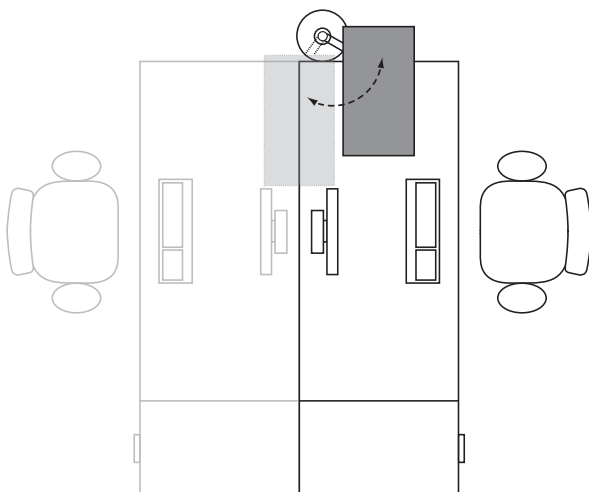

LanLight with ELDAON® light modules ...

- enables homogeneous room illumination with very uniform light distribution
- enables implementation of the EN 12464 standard
- guarantees lighting with a UGR<16 glare rating
- features a timeless, functional design
- has a pan-and-tilt luminaire head that can be precisely adjusted and aligned, meaning optimal setting for all table arrangements
- is fixed away from view in the floor cavity so that bothersome baseplates are no longer necessary
- has an integrated movement sensor and ambient light sensor
- makes available a twin-head, rotatable luminaire mounting element with 4 unit blocks

Product overview

LanLight is based upon a multifunctional system philosophy. Proceeding from the base unit, the system can be equipped with various, easy-installation modules, thus configuring it with the required functions. Special flexibility and efficiency is achieved when LanLight is used together with consolidation points (CP) for energy and data. The modules can then simply be separated from the CP and must no longer be dismantled by a specialist.



Exit Point, Flat Lid



**Exit Point
Lift Lid Set**



Bachmann
Consolidation Point
Data/Energy



Base Unit
Modular Base Unit



Self Contact



Patch Pole Holder
Installation Cone
for Patch Pole



Bachmann
PDU optional



Floor Tank
Connection Unit 8P/4S



German Socket Unit
4P/2S



Custom Module
Connection Unit 4P/2S



Bachmann
PDU optional



Bachmann
PDU optional



Floor Tank
Lift Lid Set
Self contact



Mobile Pole
Pole 650 mm



Small Pole



Bachmann
PDU optional



Luminaire Socket

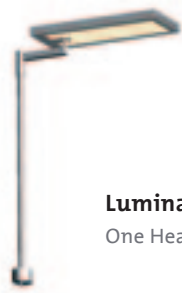

Luminaire
One Head/ Two Heads



Patch Pole
Pole 650 mm



Luminaire Socket



Luminaire
One Head/ Two Heads

**BACH
MANN**

Bachmann GmbH & Co. KG
Ernstthalenstr. 33, 70565 Stuttgart, Deutschland
Tel.: +49 711 86602-0 | Fax +49 711 86602-34
E-Mail: info@bachmann.com | Web: www.bachmann.com

siteco

Siteco Beleuchtungstechnik GmbH
Georg-Simon-Ohm-Straße 50 | 83301 Traunreut
Tel.: +49 8669 33-0 | Fax: +49 8669 33-397
E-Mail: info@siteco.de | Web: www.siteco.com